

TWP 38 S.  
 SCALE - 1" = 100'  
 SECTION - 36

"This right-of-way map when recorded is an instrument of title conveyance, transferring in accordance with Florida Statutes 337.29 (1977) all right, title, and interest of the Florida Department of Transportation in the road, street, highway, set forth on this map to \_\_\_\_\_ County."

Recorded in Public Records of \_\_\_\_\_ County, Florida, this \_\_\_\_\_ day of \_\_\_\_\_ A.D. 19\_\_\_\_ in Road Plat Book \_\_\_\_\_ Page 100

Clerk of Circuit Court  
 \_\_\_\_\_  
 County, Florida

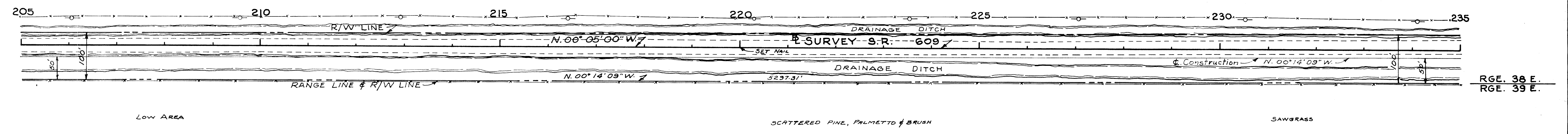

SECTION - 31

STATE OF FLORIDA  
 STATE ROAD DEPARTMENT  
**RIGHT OF WAY MAP**  
 STATE ROAD No. 609 MARTIN COUNTY

BY	DATE	APPROVED BY	DATE
D.R.L.	11-66	<i>James C. Davidson</i>	11-66
L.W.M.	11-66		
CHECKED	D.R.L.		11-66
COMPARED			
INDEXED			

SECTION 89001-2502 SHEET 8 OF 10

REVISION	BY	DATE